

# Tetra® PowerStrip

## LED Lighting System

(GEWHSSP3-65K, GEWWSSP3-41K)

### Components

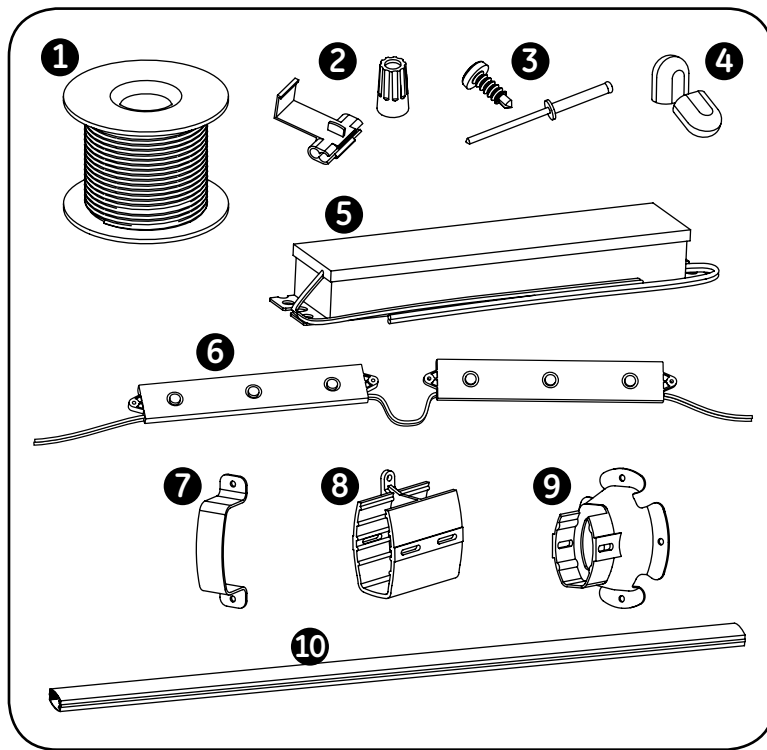

- 1 UL approved 18 AWG (0.82 mm<sup>2</sup>) supply wire
  - 2 UL approved 22-14 AWG (0.33-2.08 mm<sup>2</sup>) wire connectors or 22-18 AWG (0.33-0.82 mm<sup>2</sup>) in-line/IDC connectors
  - 3 #6 or #8 (M3 or M4) screws or 1/8 inch (3.2 mm) rivets
  - 4 End caps (GETMEC1)
  - 5 Tetra® Power Supply (GEPS12-20, GEPS12-60, GEPS12-60U)
  - 6 Tetra® PowerStrip LED modules (GEWHSSP3-65K, GEWWSSP3-41K)
- OPTIONAL**
- 7 Tetra® PowerStrip Assembly Support (GEDSAS1)
  - 8 Tetra® PowerStrip Tube Connector (GEDSTC1)
  - 9 Tetra® PowerStrip Assembly End Cap (GEDSMB1)
  - 10 Tetra® PowerStrip Tube (GEDSAT96)



### BEFORE YOU BEGIN

Read these instructions completely and carefully.

#### ⚠ WARNING/ADVERTISEMENT

**Risk of electrical shock.** Disconnect power before servicing or installing product.

**Risque de choc électrique.** Couper l'alimentation avant le dépannage ou avant l'installation du produit.

### Prepare Electrical Wiring

#### Electrical Requirements



- Do not use in wet locations.
- The grounding and bonding of the LED Driver shall be done in accordance with National Electric Code (NEC) Article 600.
- Follow all National Electric Codes (NEC) and local codes.



imagination at work

## Retrofit Preparation

Make sure the removal of lighting equipment does not compromise the integrity of the sign body (i.e. water intrusion). Fill in all holes 0.5 in. (13mm) or smaller with the appropriate amount of rated caulk or sealant. For holes greater than 0.5 in. (13mm), use an aluminum or zinc coated steel patch with rivets and sealant.

## Layout Modules

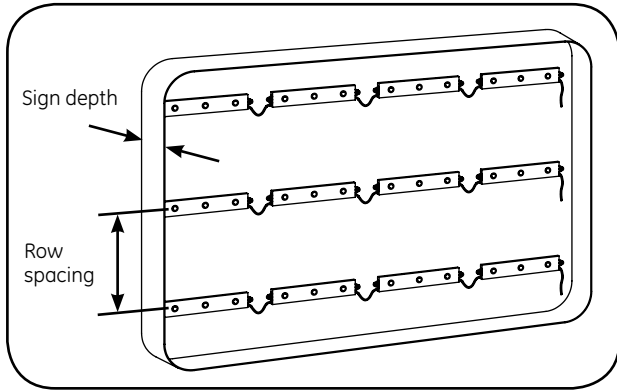

- 1 If sign depth is less than 6 inches (152 mm), space rows 10 inches (254 mm) apart. If sign depth is greater than or equal to 6 inches (152 mm), space rows 12 inches (305 mm) apart.

**NOTE:** Minimum recommended sign depth is 5 inches (127 mm).

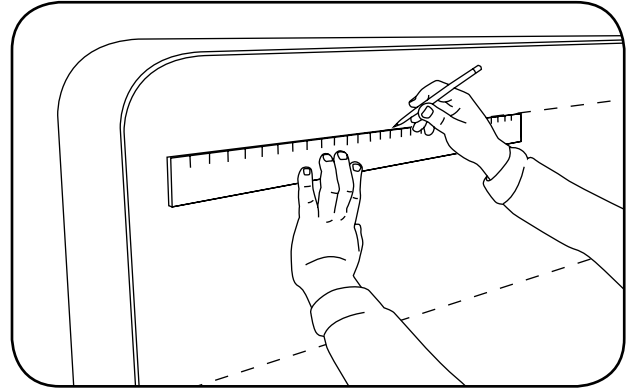

- 2 Mark row spacing guidelines so that modules are spaced evenly inside and from edges of sign.

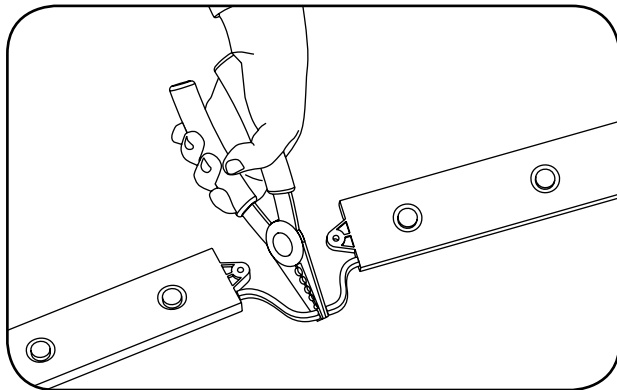

- 3 Determine how many modules are required for one row and cut wire.

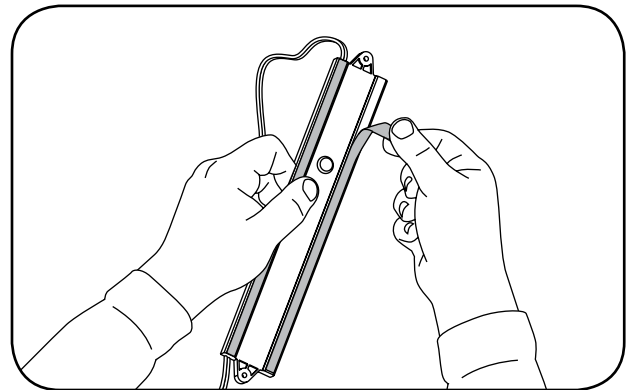

- 4 Peel off backing to expose adhesive tape.

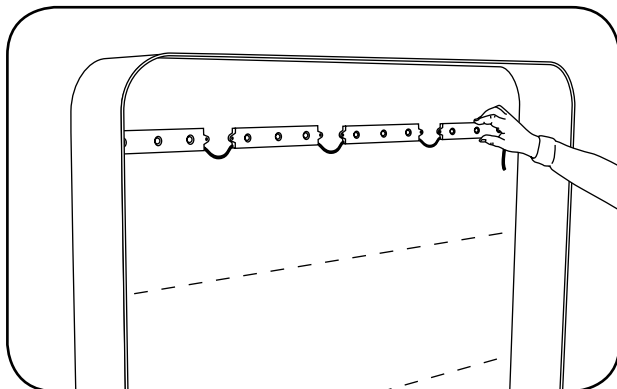

- 5 Position string of modules end to end along guidelines inside of sign. Evenly space modules by arranging approximately one module per 12 inches (305 mm).

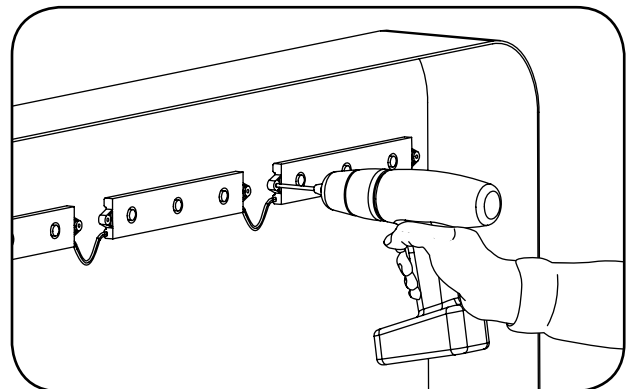

- 6 Secure with at least one screw per module with #6 or #8 (M3 or M4) screws or 1/8-inch rivets (3.175 mm).

## Electrical Connections

**NOTE:** Refer to the power supply installation instructions for loading and remote mounting information.

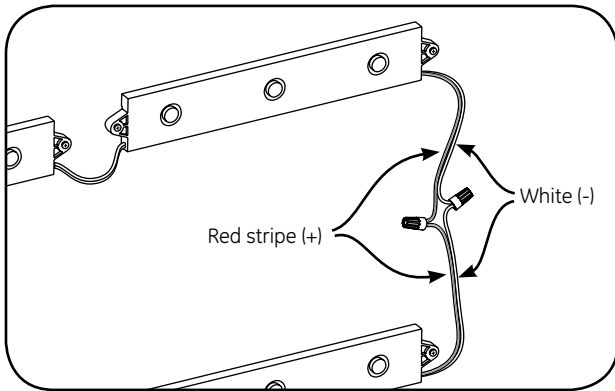

- 1 Connect modules using twist-on wire connectors or in-line (IDC) connectors. Join white wires together and red striped wires together.

**NOTE:** Additional supply wire may be necessary to bridge electrical connections.

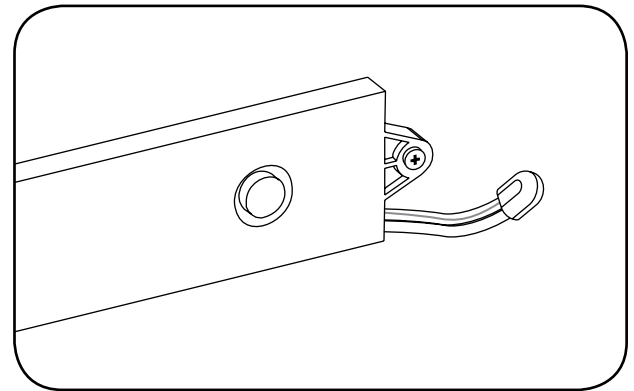

- 2 Cap all exposed wires with appropriate end caps.

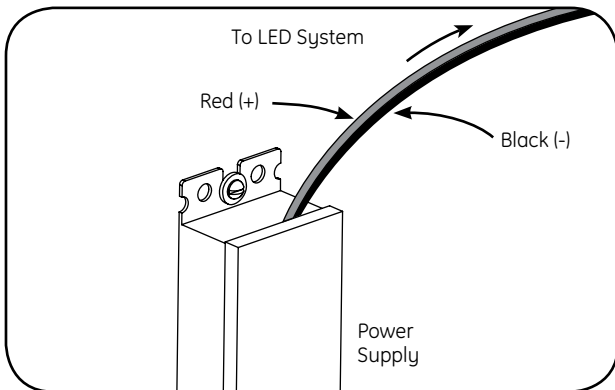

- 3 Run a wire from the power supply to inside the sign and connect to the first module on the strip.

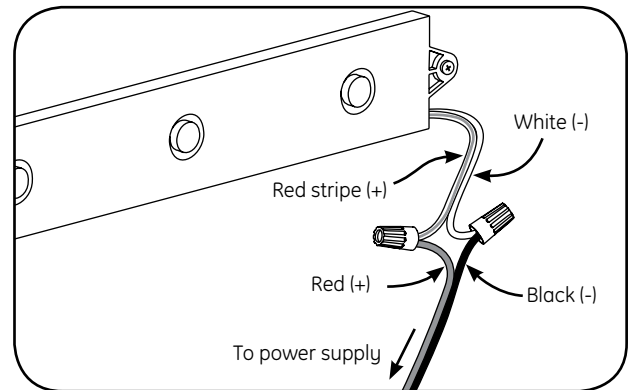

- 4 Connect the red stripe wire (+) of the LED system to the red wire (+) of the power supply. Connect the white wire (-) of the LED system to the black wire (-) of the power supply.

## OPTIONAL - Assemble and Install Tubes

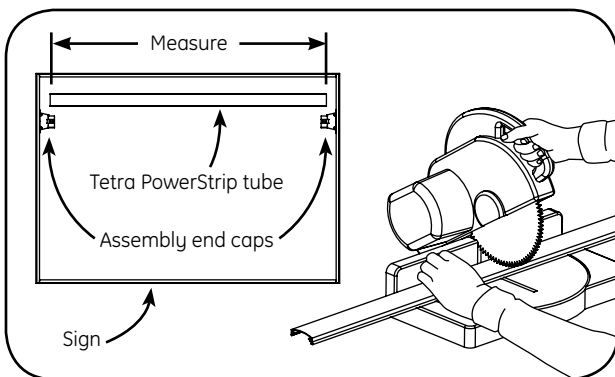

- 1 Measure and cut Tetra PowerStrip tube to the appropriate length. Allow 1.75 inches (44 mm) for each end cap. Leave a 0.25 inch (6 mm) gap between tube and assembly end cap to allow for expansion or contraction. Clean off any excess plastic debris.

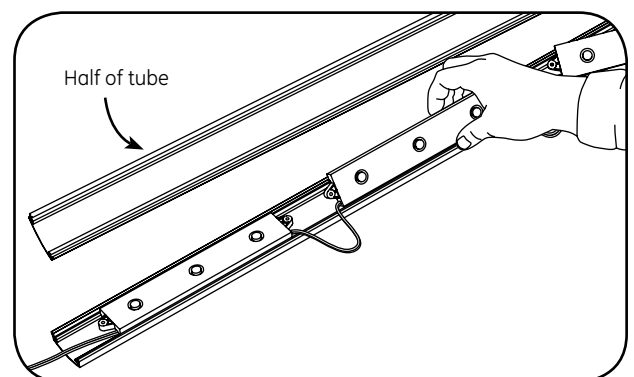

- 2 Arrange modules approximately 1 module per 12 inches (305 mm). Snap modules into half of the Tetra PowerStrip Tube.

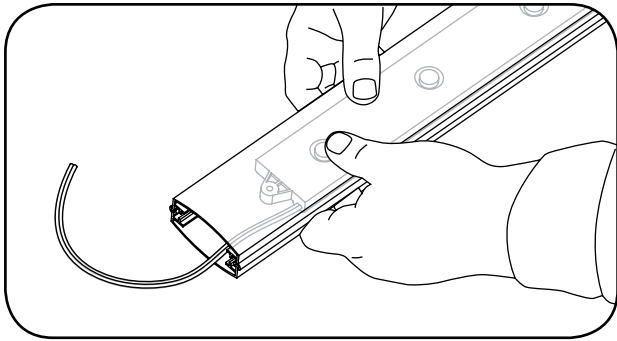

**3** Snap together tube halves.

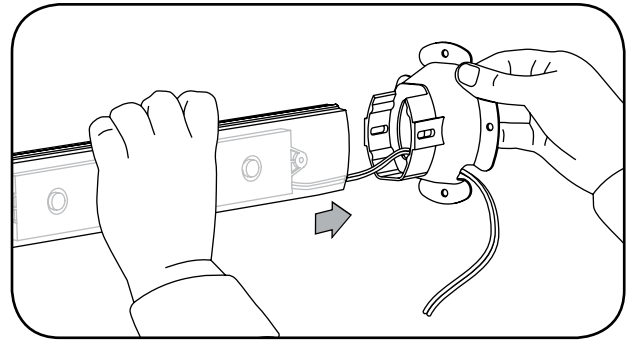

**4** Feed wire through assembly end cap and slide into assembly end cap.

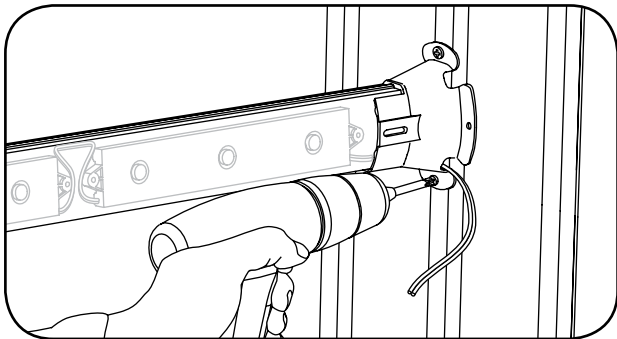

**5** Place Tetra PowerStrip Assembly into correct position and fasten assembly end cap to the sign with two #6 (M3) screws.

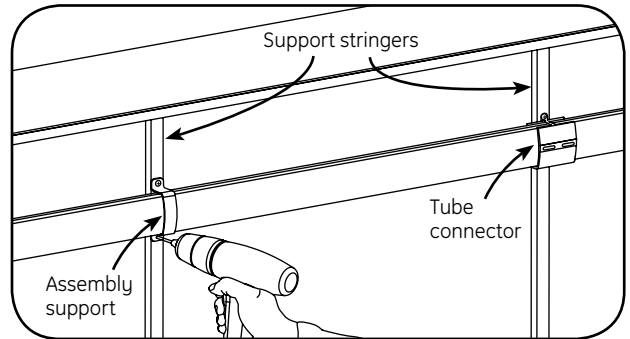

**6** When mounting horizontally assembly supports **MUST BE** used to support tubes approximately every 4 ft. (1.22 m) by mounting assembly supports around tubes and securing into support stringers with screws.

**OPTIONAL:** Install a tube connector for longer spans up to 10 ft. (3.05 m) and push tube ends into connector.

## Troubleshooting

Symptom	Solution
Row of modules does not light	<ul style="list-style-type: none"> <li>• Check wire connections to power supply to ensure red stripe-to-red and white-to-black connections.</li> <li>• Check row-to-row polarity connections.</li> </ul>
Sign does not light	<ul style="list-style-type: none"> <li>• Check input and output voltage and check power supply input/output connections.</li> <li>• Check polarity connections.</li> </ul>
Individual modules do not light	<ul style="list-style-type: none"> <li>• Remove module and replace with another working module.</li> </ul>
Modules are dim	<ul style="list-style-type: none"> <li>• Ensure the overall length of the Tetra® LED system does not exceed the maximum load.</li> <li>• Ensure the length and gauge of the supply wire is equal to or below the recommended remote mounting distance.</li> </ul>

## ⚠ WARNING!

### RISK OF ELECTRIC SHOCK:

- Turn power OFF before inspection, installation or removal.
- Properly ground Tetra Power Supply enclosure.



### RISK OF FIRE:

- Follow all NEC and local codes.
- Use only UL approved wire for input/output connections. Minimum size 18 AWG (0.82 mm<sup>2</sup>)

Conforms to the following standards:



6180 Halle Drive • Valley View, Ohio 44125-4635 • USA  
 P: 216.606.6555 • F: 216.606.6599 • www.led.com • info@led.com

For customer service & technical support, contact:  
**1-888-MY-GE-LED** (1.888.694.3533)

Lumination, LLC is a subsidiary of the General Electric Company. Tetra is a trademark of Lumination, LLC. The GE brand, logo, and ecomagination are trademarks of the General Electric Company. © 2009 Lumination, LLC. Information provided is subject to change without notice. All values are design or typical values when measured under laboratory conditions.